

# Munters Euroemme EM 50-52

## Air extraction fans

EM50, introduced in the 1980s, is one of the most well-known box fans, recognized for its excellent performance in livestock farming (broiler, layer, swine, dairy) and greenhouse applications. EM52 builds on this legacy, offering the same reliability and efficiency.

### Benefits

- Reliable, proven in the market for more than 40 years
- Superior durability with Munters Protect coating
- Light and air draft reduction, when shutter is closed
- Energy efficient solution, the EM50 E-line version saves up to 50% on electricity costs
- Suited for tunnel ventilation

EM 50-52 are the ideal exhaust fans whenever extra high airflow capacity is required, even in high static pressure environments, thanks to their unique propeller shape that ensures full efficiency and reliability.

They feature extra strength against corrosion with housing, conveyor and shutter in Munters Protect coated steel. For highly corrosive applications, the EMX50 version offers elements in stainless steel in addition to Munters Protect.

The belt drive system enables low speed, to reduce energy consumption and noise, as well as to ensure a comfortable environment for animals and operators. The EM50 E-line model reduces power consumption by up to 50% compared to the same fan with AC motor, while enabling speed regulation.

The patented centrifugal system provides an energy efficient solution and powerful springs keep shutters tightly closed when the fan is not turned on, avoiding air leakage and blocking light.

As the market leader in ventilation solutions for more than 60 years, GrainProteinTech Climate Control & Air Treatment guarantees quality and is ISO 9001 certified.



EM50 E-line

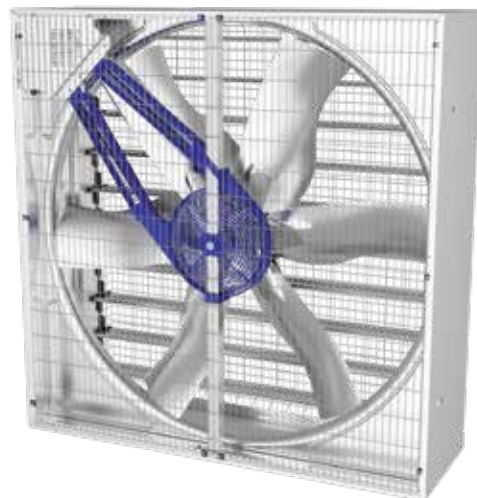

EM52



Proudly manufactured with 100% renewable energy in our plants in Italy

# Munters Euroemme EM50

## AC motor

### Dimensions

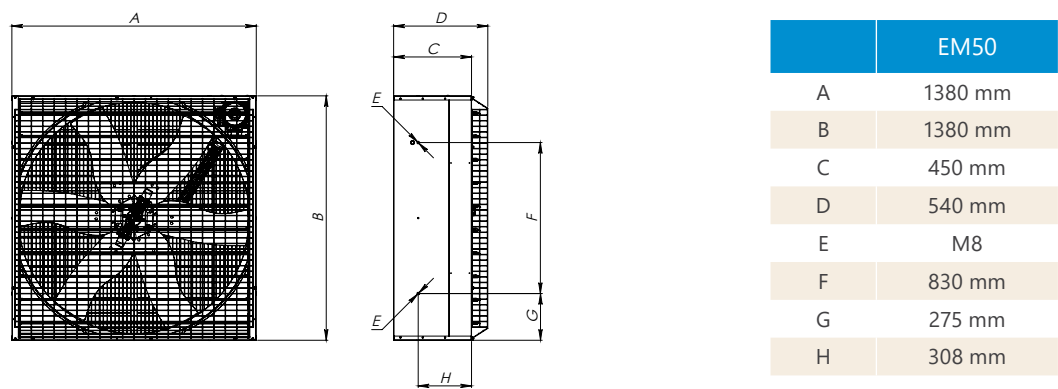

### Technical specifications

		EM50 Belt 1.0	EM50 Belt 1.5
Nominal power	hp	1.0	1.5
Propeller diameter	mm [inch]	1270 [50]	
Number of blades/material		6/Munters Protect	
Number of shutter blades		10	
Motor/drive type		AC/Belt	
Weight of fully equipped fan	kg	84	86
Max power consumption/max current <sup>1</sup>	W/A	1150/2.1	1810/3.3
Max operating temperature	°C [°F]	50 [122]	
Max operating pressure	Pa	50	
Motor insulation grade/protective class		F/IP55	
Noise level <sup>2</sup>	Db(a)	67.6	70.4

<sup>1</sup>50 Hz 400 V specification, 60 Hz available upon request, <sup>2</sup>Noise measure made according to ISO 3744

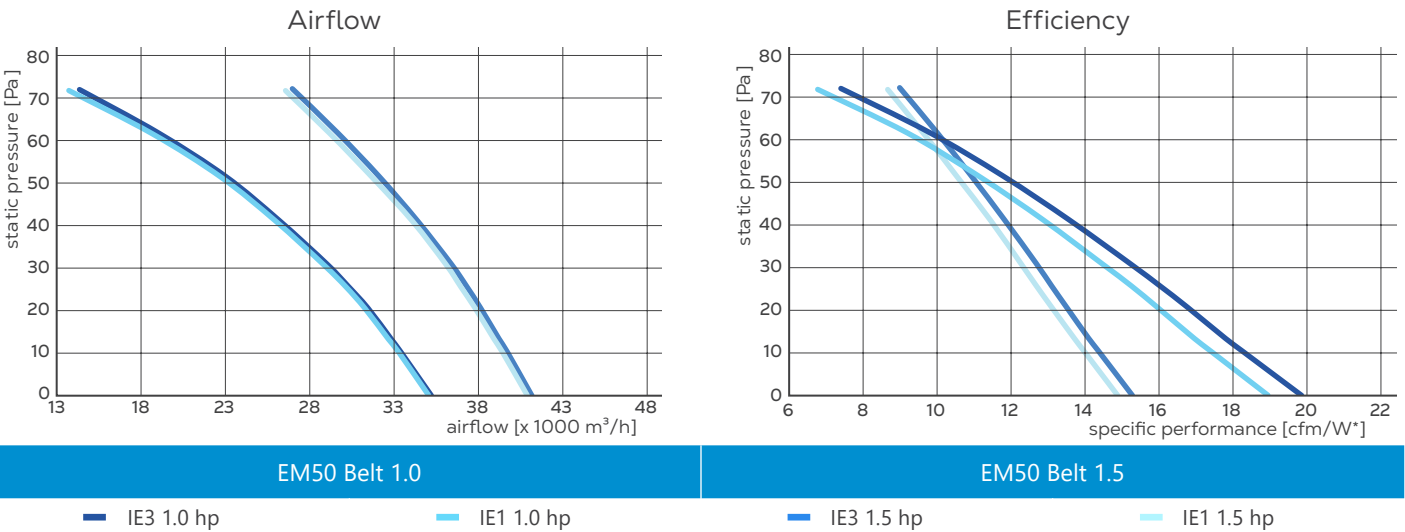

Airflow and efficiency tested in the test chamber in accordance with ANSI/AMCA 210/15 Standard, certified by BESS Lab. \*1 cfm/W = 1.7 (m³/h)/W

### Load capacity

	EM50 Belt 1.0/1.5	
	Unassembled	Assembled
40' HC container	300	57
13.6 m truck	328	65

Pyramidal mesh for installation below 2.7 m available upon request.

# Munters Euroemme EM50

## E-line

### Dimensions

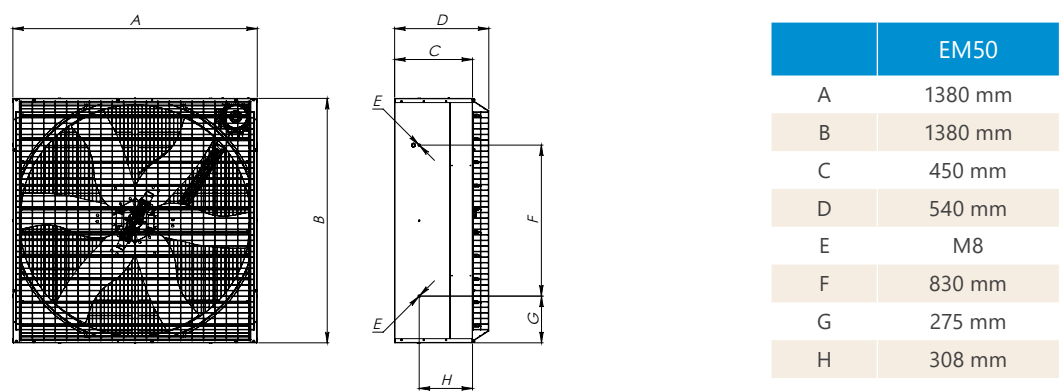

### Technical specifications

		EM50 E-line
Nominal power	hp	2.5
Propeller diameter	mm [inch]	1270 [50]
Number of blades/material		6/Munters Protect
Number of shutter blades		10
Motor/drive type		EC/Belt
Weight of fully equipped fan	kg	87
Max power consumption/max current <sup>1</sup>	W/A	1600/3.2
Max operating temperature	°C [°F]	50 [122]
Max operating pressure	Pa	50
Motor insulation grade/protective class		H/IP66
Noise level <sup>2</sup>	Db(a)	70.3

<sup>1</sup>400 V specification, <sup>2</sup>Noise measure made according to ISO 3744

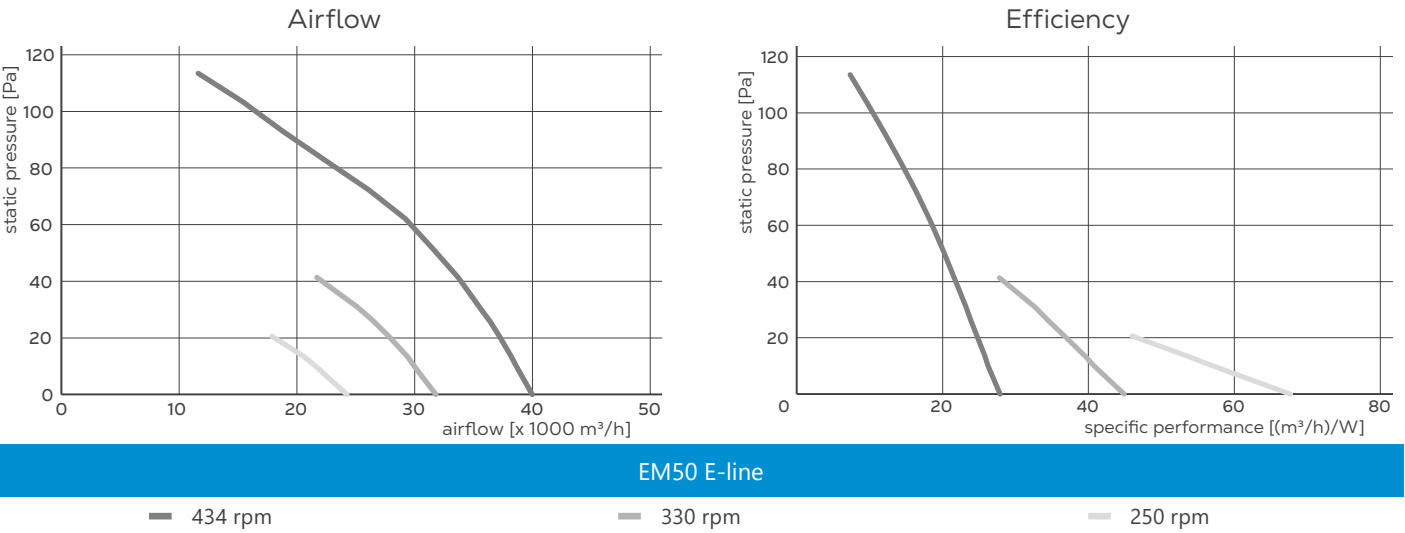

Airflow and efficiency tested in the test chamber in accordance with ANSI/AMCA 210/15 Standard, certified by BESS Lab.

### Load capacity

	EM50 E-line	
	Unassembled	Assembled
40' HC container	250	57
13.6 m truck	-	65

Pyramidal mesh for installation below 2.7 m available upon request.

# Munters Euroemme EM52

## AC motor

### Dimensions

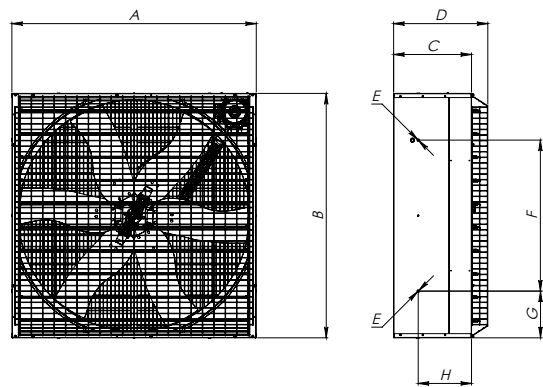

	EM52
A	1425 mm
B	1425 mm
C	455 mm
D	545 mm
E	M8
F	830 mm
G	298 mm
H	310 mm

### Technical specifications

		EM52
Nominal power	hp	2.0
Propeller diameter	mm [inch]	1334 [52]
Number of blades/material		6/Munters Protect
Number of shutter blades		10
Motor/drive type		AC/Belt
Weight of fully equipped fan	kg	90
Max power consumption/max current <sup>1</sup>	W/A	1770/3.5
Max operating temperature	°C [°F]	50 [122]
Max operating pressure	Pa	100
Motor insulation grade/protective class		F/IP55
Noise level <sup>2</sup>	Db(a)	70.3

<sup>1</sup>50 Hz 400 V specification, 60 Hz available upon request, <sup>2</sup>Noise measure made according to ISO 3744

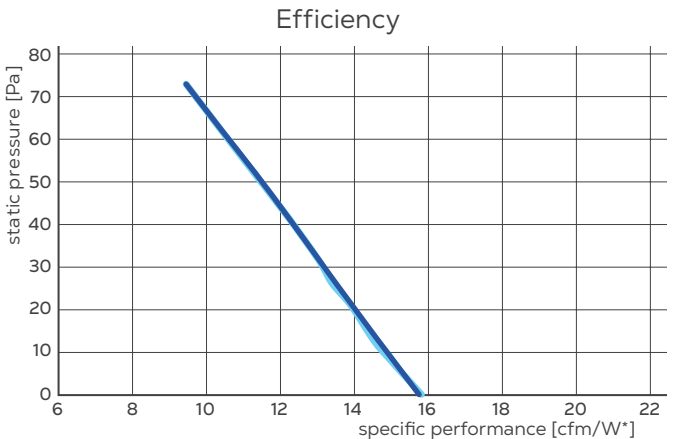
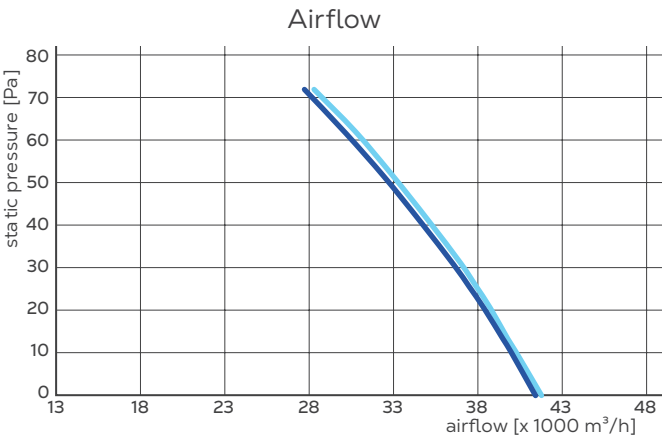

EM52	
IE3 2.0 hp	IE1 2.0 hp

Airflow and efficiency tested in the test chamber in accordance with ANSI/AMCA 210/15 Standard, certified by BESS Lab. \*1 cfm/W = 1.7 (m³/h)/W

### Load capacity

	EM52	
	Unassembled	Assembled
40' HC container	300	57
13.6 m truck	328	64

Pyramidal mesh for installation below 2.7 m available upon request.